

No.H.11034/1/2020-DC(KZL)
OFFICE OF THE DISTRICT ELECTION OFFICER
KHAWZAWL DISTRICT: KHAWZAWL

Khawzawl, the 15th July, 2021.

To

The Jt. Chief Electoral Officer
Mizoram : Aizawl.

**Subject: Detailed estimate for construction of EVM Strongroom in
respect of DEO Office, Khawzawl – submission of**

Sir,

With reference to the subject cited above, I have the honour to submit herewith detailed estimate for construction of EVM Strongroom/Warehouse at Khawzawl within the premises of office of the District Election Officer, Khawzawl District as EVM Strongroom is not yet available in the District for storage of EVMs and VVPATs.

This is for your kind information and necessary action.

15.7.21

(ZOTHANMAWIA)

Deputy Election Officer

Khawzawl District, Khawzawl.

NAME OF WORK : DETAILED ESTIMATE FOR CONSTRUCTION OF EVM STRONG-ROOM / WAREHOUSE AT KHAWZAWL .

(As per Mizoram P.W.D. SOR - 2019)

Sl.No.	ITEMS OF WORK	No.	L (M)	B (M)	H (M)	Unit	Qty.	Rate (in Rs.)	Amount (in Rs.)
1/2.07	Earthwork in excavation in foundation trenches or drains etc. (not exceeding 1.5m in width or 10sqm on plan) including dressing of sides and ramming of bottoms, lift upto 1.5m including getting out excavated soil and disposal of surplus excavated soil as directed within a lead of 50 metres.								
	<i>(b) Hard Soil</i>								
	<i>Site Development</i>	1	10.00	7.00	2.00	cum	140.00		
	<i>Foundation</i>	6	1.80	1.80	1.50		29.16		
						<i>Sub-total</i>	169.16	629.90	106,553.88
2/4.03	Providing and laying in position cement concrete of specified grade excluding cost of centering and shuttering -All work upto plinth level:								
	<i>(a) 1:3:6 (1 cement :3 course sand :6 stone aggregate 20mm nominal size)</i>								
		6	1.80	1.80	0.15	cum	2.92		
	<i>R/Wall</i>	1	18.00	1.10	0.15		2.97		
						<i>Sub-total</i>	5.89	7350.60	43,295.03
3/7.08	Coursed masonry with rectangular sized hard stone in foundation upto one storey above and below ground level including curing, etc. complete.								
	<i>(a) in cement mortar 1 : 3 (1cement : 3 fine sand</i>								
	<i>Block-I</i>	1	8.00	0.65	2.00	cum	10.40		
	<i>Block-II</i>	1	5.00	0.60	2.00		6.00		
	<i>Block-III</i>	1	5.00	0.60	2.00		6.00		
						<i>Sub total</i>	22.40	9190.40	205,864.96
4/5.03	Reinforced cement concrete work in beams, suspended floors, roofs having slope up to 15° landings, balconies, shelves, chajjas, lintels, bands, plain window sills, staircases and spiral stair cases above plinth level up to floor five level, excluding the cost of centering, shuttering, finishing and reinforcement complete.								
	<i>(a) 1:1.5:3 (1 cement : 1.5 coarse sand : 3 graded stone aggregate 20mm nominal size)</i>								
	<i>Foundation</i>	6	1.20	1.20	0.40	cum	3.46		
	<i>Column</i>	6	0.30	0.30	4.00		2.16		
	<i>Tie-Beam</i>	2	7.32	0.20	0.30		0.88		
		3	4.57	0.20	0.30		0.82		
	<i>Beam</i>	2	8.12	0.25	0.35		1.42		
	3	5.37	0.25	0.35	1.41				

Sl.No.	ITEMS OF WORK	No.	L (M)	B (M)	H (M)	Unit	Qty.	Rate (in Rs.)	Amount (in Rs.)	
	<i>Floor</i>	1	7.32	4.57	0.10	<i>cum</i>	3.35			
	<i>Slab</i>	1	8.12	5.37	0.12		5.23			
						<i>Sub-Total</i>	18.73	9811.30	183,765.65	
	Steel reinforcement for RCC work including straightening, cutting, bending, placing in position and binding all complete. (b) <i>Thermo-Mechanically Treated bars of grade Fe-500 or more.</i>									
5/5.18	Foundations	3.46 m ³ @ 100 kg / m ³			<i>kg</i>		346.00			
	Column	2.16 m ³ @ 310 kg/m ³					669.60			
	Beams	4.53 m ³ @ 270 kg/m ³					1223.10			
	Slab	8.58 m ³ @ 100 kg/m ³					858.00			
						<i>Sub-Total</i>	3096.70	101.60	314,624.72	
	Centering and shuttering including strutting,propping etc.And removal of form for: (a) <i>Foundations, footings,etc.</i>									
	<i>Foundation</i>	6	4.80		0.40	<i>sqm</i>	11.52	359.10	4,136.83	
	(c) <i>Columns, pillars, piers,etc.</i>									
	<i>Column</i>	6	1.20		4.00	<i>sqm</i>	28.80	618.40	17,809.92	
	(d) <i>Lintels, beams, plinth beams,etc.</i>									
6/5.10	<i>Beam</i>	2	8.12	0.25			4.06			
		4	8.12		0.35		11.37			
		3	5.37	0.25			4.03			
		6	5.37		0.35		11.28			
						<i>Sub-Total</i>	30.74	480.10	14,758.27	
	(e) <i>Suspended floors, roofs,etc.</i>									
	<i>Slab</i>	1	8.12	5.37		<i>sqm</i>	43.60	673.30	29,355.88	
	Half brick masonry with first class brick in superstructure above plinth level upto floor V level. (a) <i>in cement mortar 1:3 (1 cement : 3 coarse sand)</i>									
7/6.06	<i>Wall</i>	2	7.32		3.30	<i>sqm</i>	48.31			
		2		4.57	3.30		30.16			
	Deduction for Doors									
	<i>D</i>	-1	1.50		2.00		-3.00			
						<i>Sub-Total</i>	75.47	1674.50	126,374.52	

Sl.No.	ITEMS OF WORK	No.	L (M)	B (M)	H (M)	Unit	Qty.	Rate (in Rs.)	Amount (in Rs.)	
8/9.06	Providing 1st class local wood dressed in frames of chaukat for doors, windows, clerestory windows fixed in position.									
	D	2	1.50	0.10	0.10	cum	0.03			
		2	2.00	0.10	0.10		0.04			
	<i>Sub-Total</i>							0.07	51372.80	3,596.10
9/9.11	Providing and fixing 1st class local wood panelled shutters for doors etc. including M.S. butt hinges with necessary screws, etc. complete. (a) 40 mm thick									
	D	1	1.50		2.00	sqm	3.00	3323.60	9,970.80	
10/14.17	Providing and fixing M.S. Oxidised sliding door bolts (aldrops) bright finished and/or black enamelled with nuts and screws etc. complete. (a) 300 x 16 mm									
		2				No.	2.00	394.60	789.20	
11/20.15	20mm cement plaster 1 : 3 (1 cement : 3 fine sand).									
	Wall	4	7.32		3.30	sqm	96.62			
		4		4.57	3.30		60.32			
	Deduction for Doors & Exhaust									
	D	-1	1.50		2.00		-3.00			
	Exhaust	-1	3.14		0.04		-0.13			
	<i>Sub-Total</i>							153.81	409.68	63,012.88
12/12.12	Providing & laying vitrified floor tiles in different sizes (thickness to be specified by the manufacture) with water absorption less than 0.08% and conforming to IS:15622, of approved make, in all colours and shades, laid on bed of 20mm thick cement mortar 1 : 4 (1 cement:4course sand), including the joints with white cement and matching pigments etc.complete.as per design collours. (b) Nano tech (Single charge)									
		1	7.32	4.57		sqm	33.45	2053.90	68,702.96	
13/20.72	Painting with synthetic enamel paint of approved brand and manufacture in all shades on new work (two or more coats). (b) High gloss									
	<i>Qty. taken from SI.No.11/20.15</i>						sqm	153.81	142.90	21,979.45
Grand Total									1,214,591.05	
Say									1,214,500.00	
(Rupees twelve lakh fourteen thousand five hundred) only.										

Prepared By :-

Sl.No.	ITEMS OF WORK	No.	L (M)	B (M)	H (M)	Unit	Qty.	Rate (in Rs.)	Amount (in Rs.)	
8/9.06	Providing 1st class local wood dressed in frames of chaukat for doors, windows, clerestory windows fixed in position.									
	D	2	1.50	0.10	0.10	cum	0.03			
		2	2.00	0.10	0.10		0.04			
	<i>Sub-Total</i>							0.07	51372.80	3,596.10
9/9.11	Providing and fixing 1st class local wood panelled shutters for doors etc. including M.S. butt hinges with necessary screws, etc. complete. (a) 40 mm thick									
	D	1	1.50		2.00	sqm	3.00	3323.60	9,970.80	
10/14.17	Providing and fixing M.S. Oxidised sliding door bolts (aldrops) bright finished and/or black enamelled with nuts and screws etc. complete. (a) 300 x 16 mm									
		2				No.	2.00	394.60	789.20	
11/20.15	20mm cement plaster 1 : 3 (1 cement : 3 fine sand).									
	Wall	4	7.32		3.30	sqm	96.62			
		4		4.57	3.30		60.32			
	Deduction for Doors & Exhaust									
	D	-1	1.50		2.00		-3.00			
	Exhaust	-1	3.14		0.04		-0.13			
	<i>Sub-Total</i>							153.81	409.68	63,012.88
12/12.12	Providing & laying vitrified floor tiles in different sizes (thickness to be specified by the manufacture) with water absorption less than 0.08% and conforming to IS:15622, of approved make, in all colours and shades, laid on bed of 20mm thick cement mortar 1 : 4 (1 cement:4course sand), including the joints with white cement and matching pigments etc. complete. as per design collours. (b) Nano tech (Single charge)									
		1	7.32	4.57		sqm	33.45	2053.90	68,702.96	
13/20.72	Painting with synthetic enamel paint of approved brand and manufacture in all shades on new work (two or more coats). (b) High gloss									
	<i>Qty. taken from Sl.No.11/20.15</i>						sqm	153.81	142.90	21,979.45
Grand Total									12,14,591.05	
Say									12,14,500.00	
(Rupees twelve lakh fourteen thousand five hundred) only.										

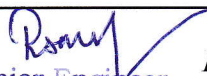
 Junior Engineer
 UD&PA
 Khawzawl District
 Prepared By :-

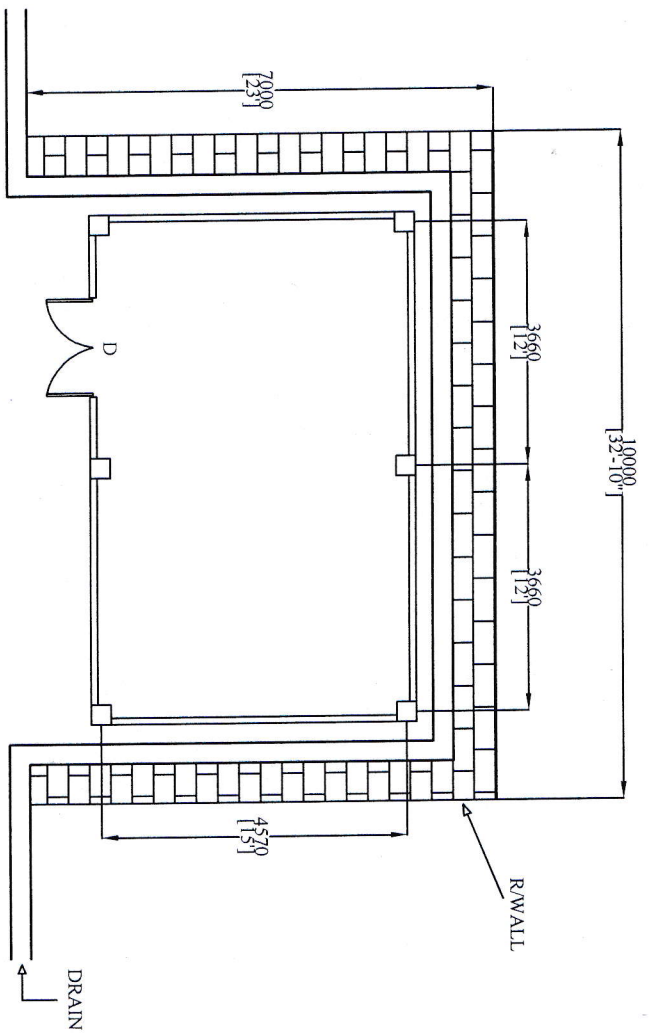

Fig. PLAN

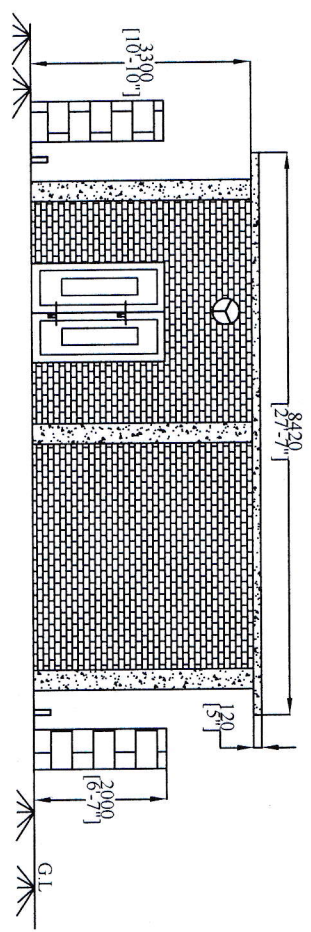

Fig. FRONT ELEVATION

Ram
 Junior Engineer
 UD&PA
 Khawzawl District